

Typical cross section  
1:25

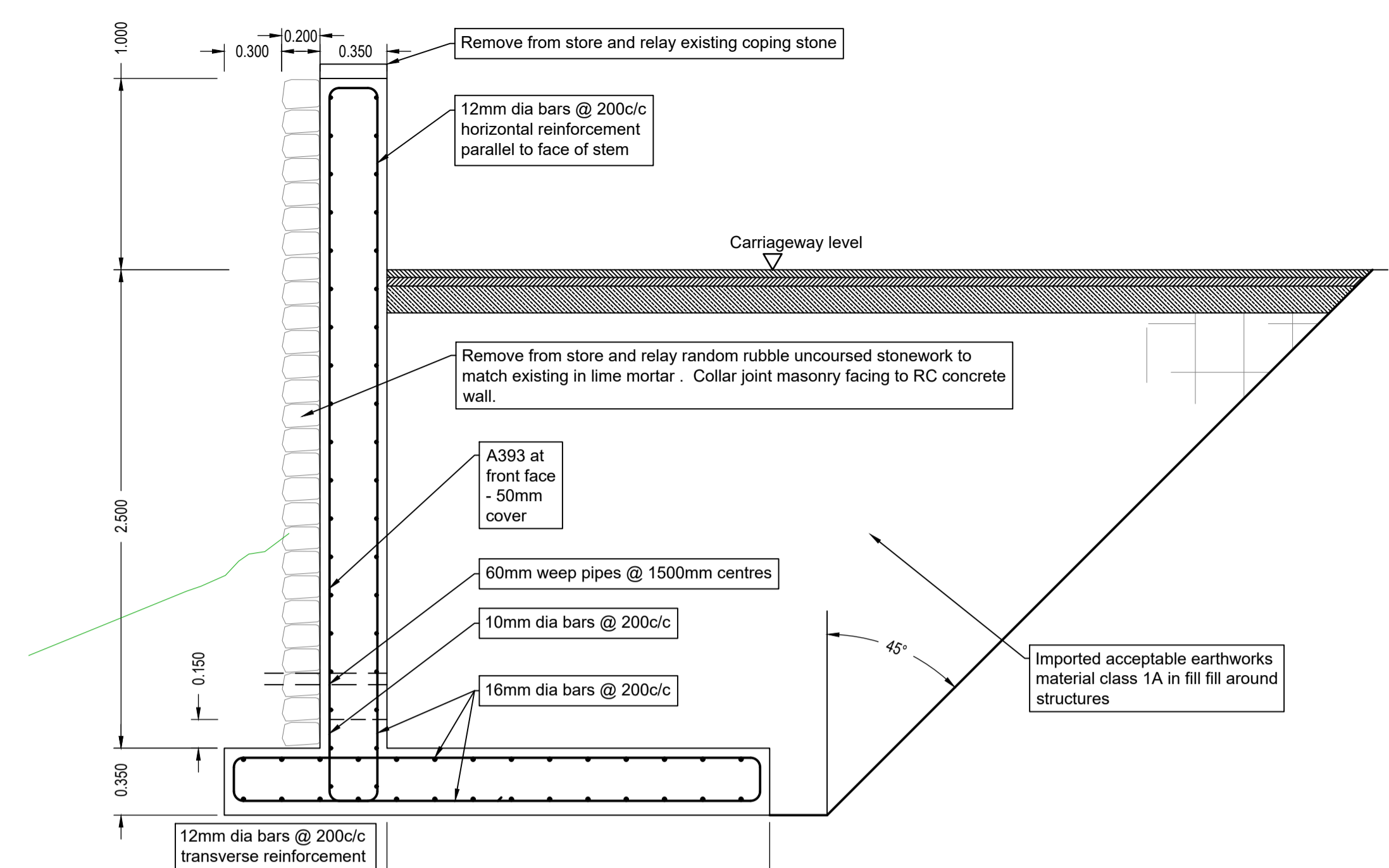

Side retaining wall cross section  
1:25

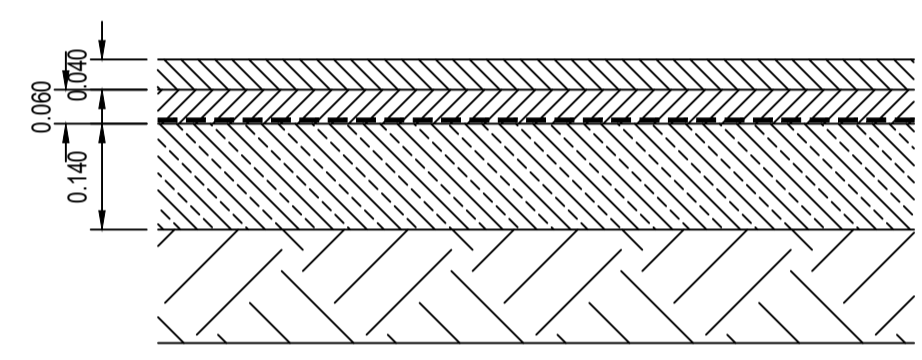

- Surface Course 40mm Hot Rolled Asphalt high stone content 55PSV 125 pen 10mm aggregate
- Binder Course 60mm Dense Bitumen Macadam 125 pen 20mm aggregate
- Bond Coat K140 at 0.3-0.5 l/m2 rate of spread
- Base Layer 140mm Dense Bitumen Macadam 125 pen 32mm aggregate

P1 Pavement Construction  
Scale 1:10

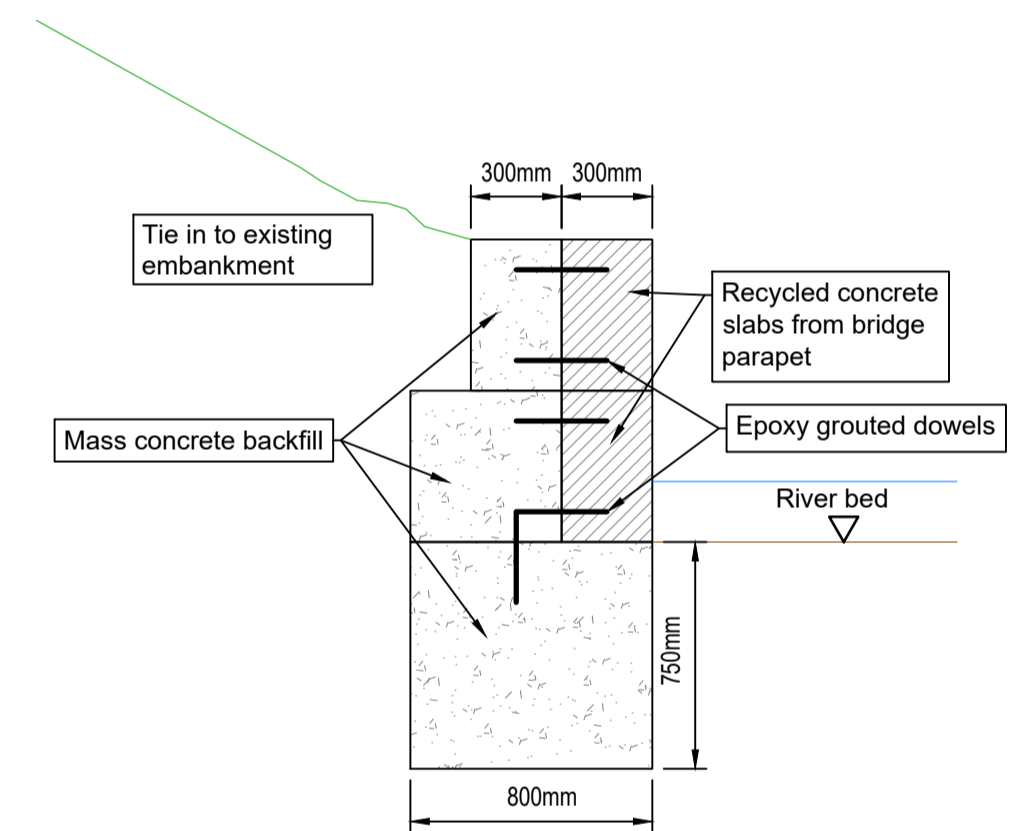

Typical training wall cross section  
1:25

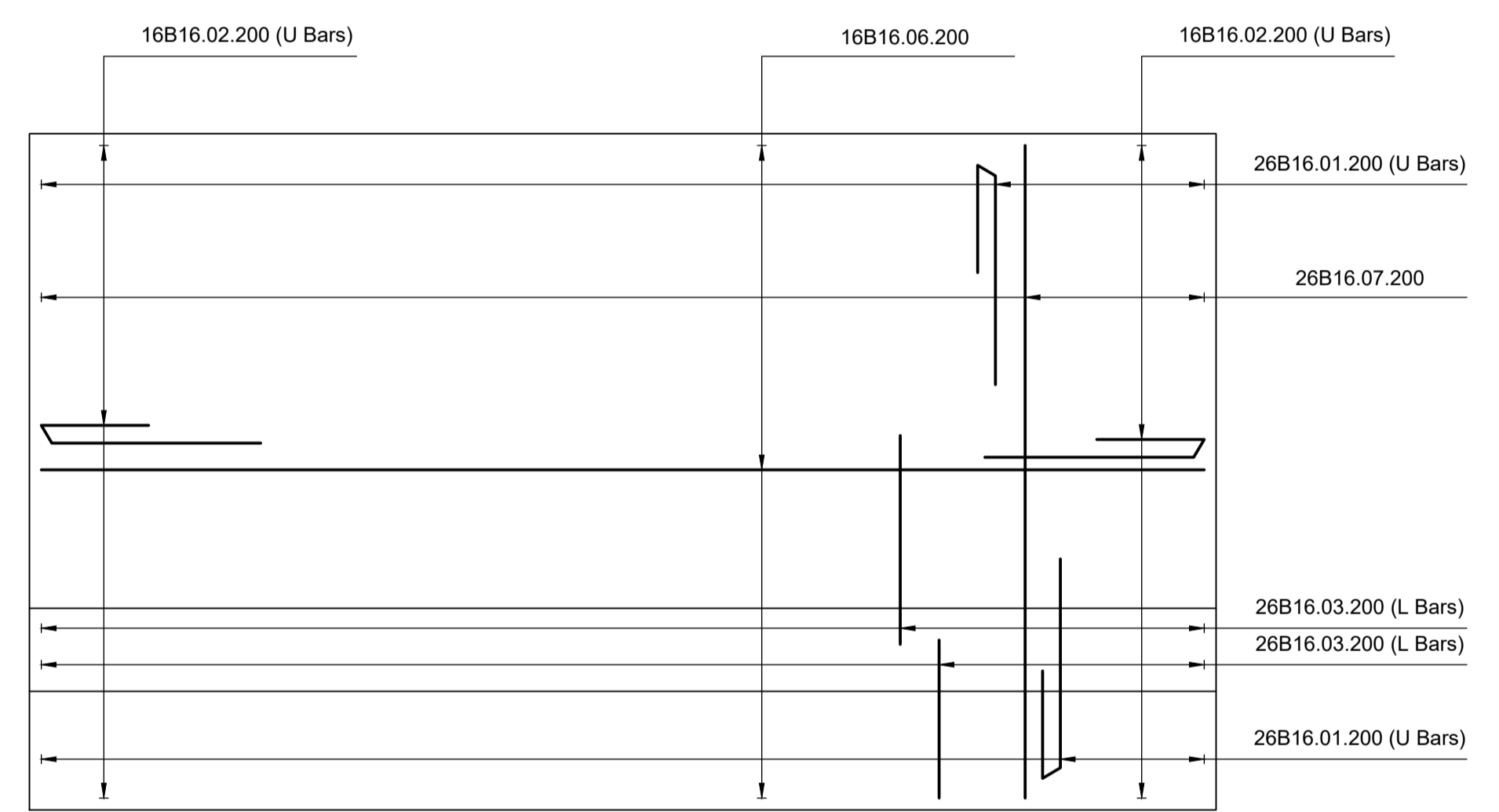

Plan  
Scale 1:25

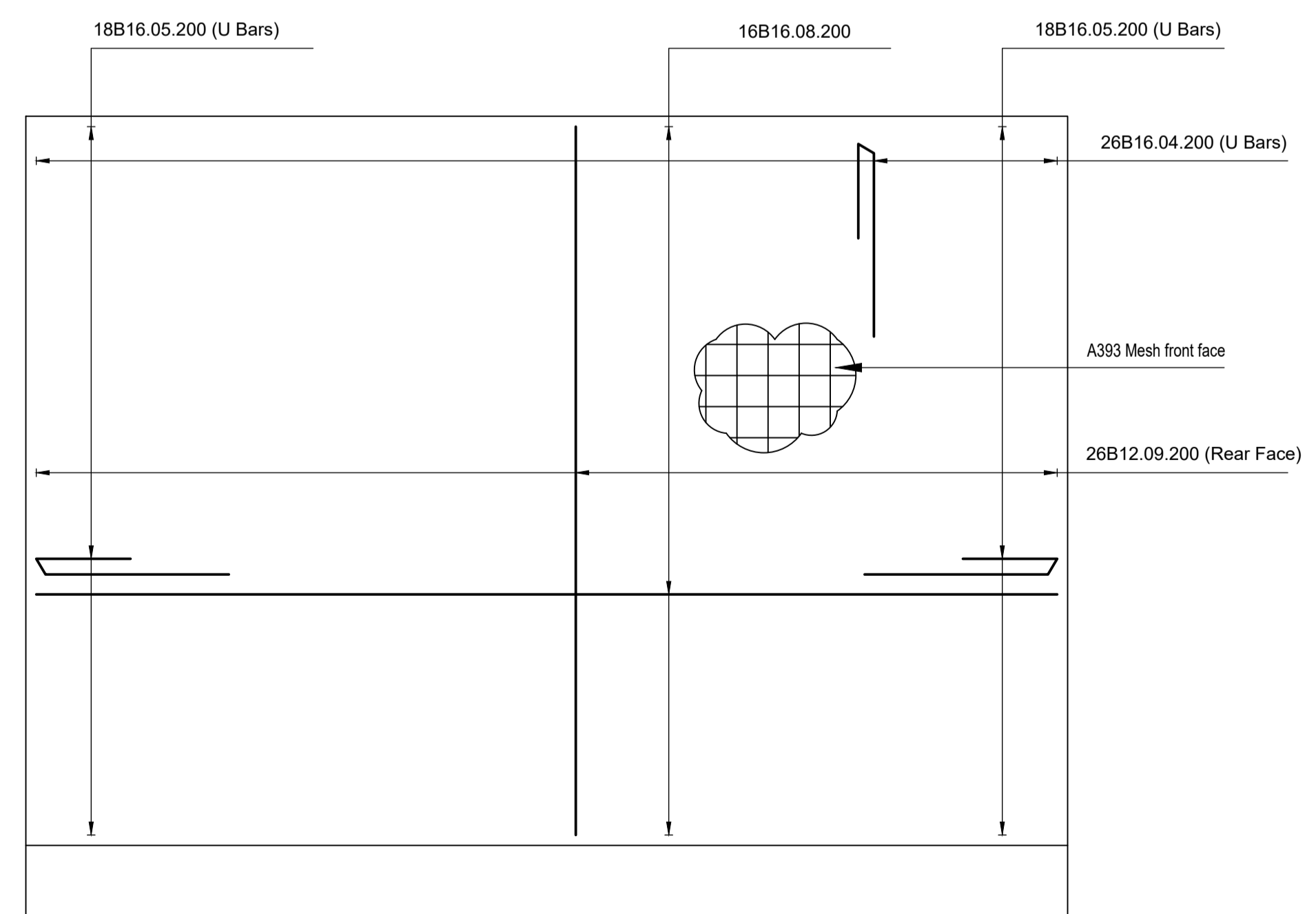

Elevation  
Scale 1:25

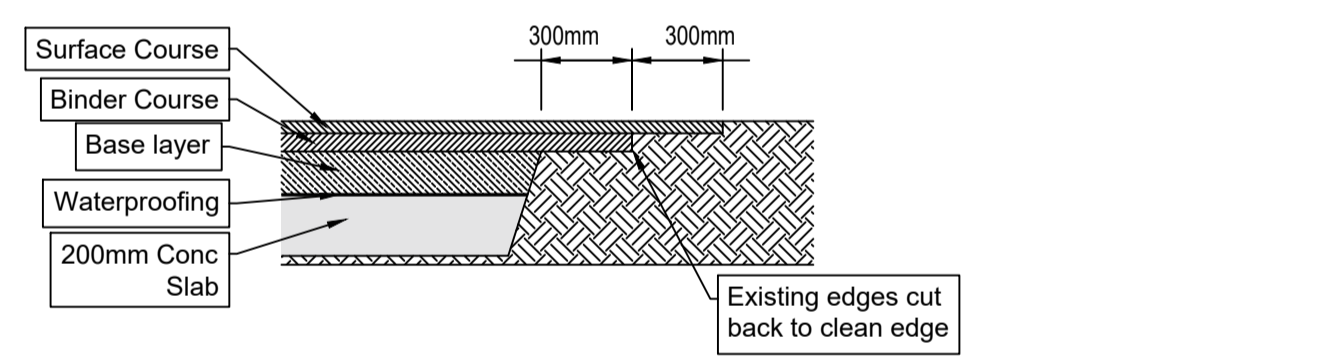

Tie in detail  
(Cross section showing Longitudinal joint where edge of new carriageway abuts an existing road)  
Scale 1:25

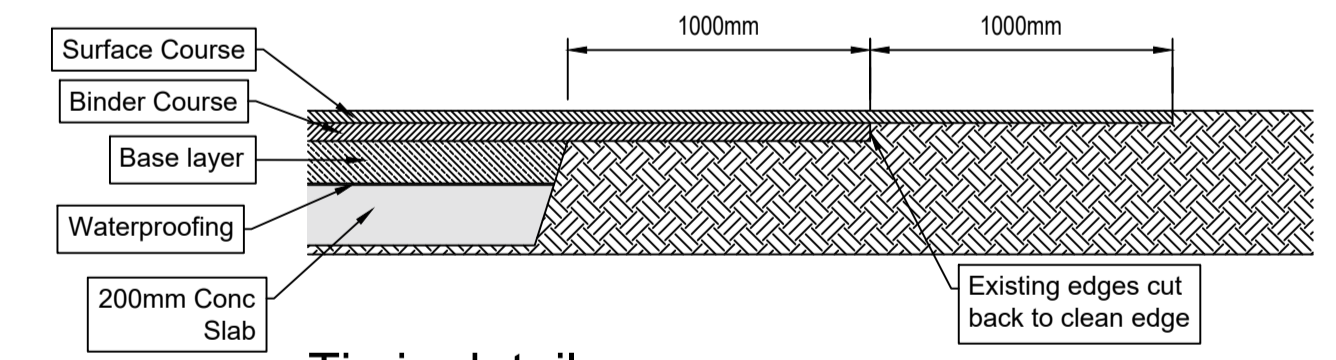

Tie in detail  
(Longitudinal section showing transverse joint across carriageway where new road extends an existing road)  
Scale 1:25

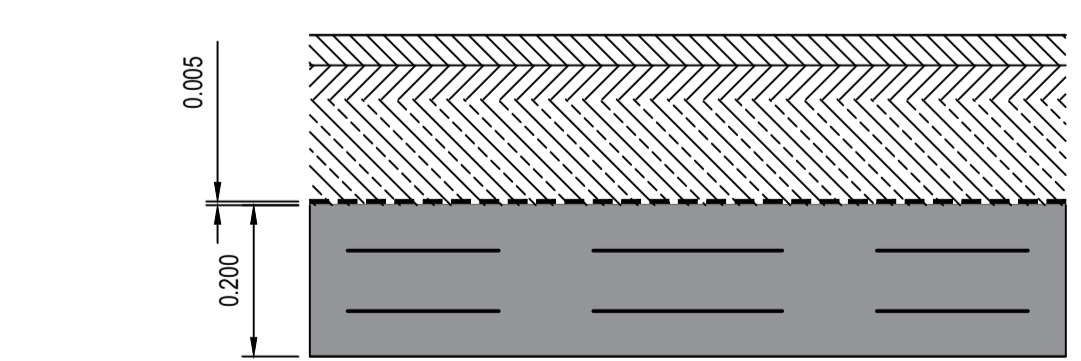

- Waterproofing concrete deck of highway surface with SERVIDEK®/SERVIPAK® layer to be 5mm thick and in accordance with CD355 DMRB.
- C40/50 200mm concrete slab
- A393 mesh nominal 50mm cover top and sides & 75mm to bottom.

Waterproofing - Cross Section  
1:10



Schwegler or similar approved  
1 x Schwegler® 1B hole type nest box (to be erected above 3m in woodland to the east of the bridge)  
1 x Schwegler® 2H open-fronted nest box (to be erected above 3m in woodland to the east of the bridge)



Schwegler or similar approved  
1x No. 9 (or equivalent) wagtail box to be fitted with the entrance facing downwards, either beneath the bridge (or if that is not possible) on a downward-facing rock ledge near the watercourse



Schwegler or similar approved  
1 x A Schwegler® (or equivalent) 1FF bat box to be erected above 3m in the woodland to accommodate any displaced bats

- NOTES
1. All chainages are in metres unless otherwise stated.
  2. All levels are in metres relative A.O.D.
  3. All dimensions are in millimetres and all levels in metres unless stated otherwise.
  4. This drawing is to be read in conjunction with all relevant architect's, engineer's and other specialist drawings.
  5. All dimensions shall be confirmed by the Contractor and any discrepancies brought to the attention of the Supervisor as soon as a discrepancy arises.
  6. All levels shown on this drawing are nominal and must be checked/agreed prior to construction. All levels to be agreed with the supervisor.

KEY

A	Issue For Tender	JAC	GRJ	2026-04-27
REV	DETAIL	DRAWN	CHECKED	DATE

PROJECT  
**Pont Segrwyd**

TITLE  
**Proposed Construction Details**

CLIENT  
**Flood Risk and Infrastructure**

SCALE @ A1:	DRAWN:	CHECKED:	APPROVED:	DWG STATUS:
As shown	JAC	GRJ	BS	Tender
	DATE:	DATE:	DATE:	
	2026-03-31	2026-03-31	2026-05-13	

**CONWY**  
CYNGOR BWRDEISTREF SIROL  
COUNTY BOROUGH COUNCIL

**ENVIRONMENT, ROADS & FACILITIES**  
G.B. Edwards BEng (Hons) CEng FICE  
Head of Environment Roads & Facilities,  
PO Box 1, Colwyn Bay, LL29 9GG.  
Tel: (01452) 575337  
E-mail: erf@conwy.gov.uk

PROJECT Ref:	DRAWING No:	REV
ERCF2509N 14 /	T105	A